

25G PON ONU SFP28

Contact: slee@cosemi.com

krhie@cosemi.com

- IEEE's new 25G PON standardization was completed in 802.3ca
- 25GBASE-PQX-U3/D3 compatible PMD specification (high power class)
 - Tx average launch power: max. +9dBm
 - ER: min. 5dB
 - Wavelength: 1300 +/-10 nm
 - OMA sensitivity: max. -24.1 dBm @BER10-2
 - Channel insertion loss: 29dB (20km with 1:32 split)
 - Coexistence with 10G EPON
 - Provide MSA's 25GS-PON compatibility
- Sample available in Q4, 2021

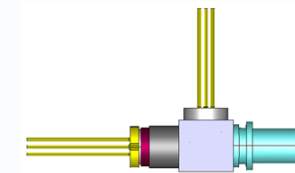

25G EPON ONU BiDi

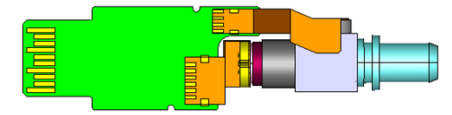

25G EPON ONU SFP28 PCB layout

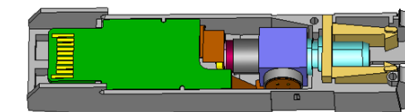
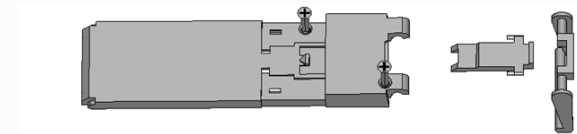

25G EPON ONT SFP28 transceiver